

Stub Ends - As Formed

Select Schedule:

5S - Featherweight

10S - Light I.P.S.

Stainless Steels: Types 304, 304L, 304H, 316, 316L, 316H

Inco Alloys: Monel 400, Nickel 200

Aluminum Alloys: Types 3003-F, 6061-T6

Other Alloys: Inquire

** Approx. weight is for stainless steel

For nickel alloys, multiply by 1.12

For aluminum alloys, multiply by .33

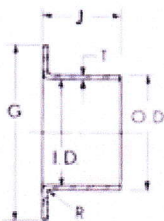

Schedule 5S Stainless steel alloys only

Nominal pipe size	Outside diameter (O.D.)	Schedule 5S					
		Diameter (G)	Length (J)	Radius (R)	Inside diameter	Wall thickness (T)	Approx. weight **
1/2	.840	1-3/8	2	1/32	.710	.065	.13
3/4	1.050	1-11/16	2	1/32	.920	.065	.14
1	1.315	2	2	1/32	1.185	.065	.19
1-1/4	1.660	2-1/2	2	1/32	1.530	.065	.21
1-1/2	1.900	2-7/8	2	1/32	1.770	.065	.29
2	2.375	3-5/8	2-1/2	1/32	2.245	.065	.44
2-1/2	2.875	4-1/8	2-1/2	1/32	2.709	.083	.75
3	3.500	5	2-1/2	1/32	3.334	.083	.94
4	4.500	6-3/16	3	1/32	4.334	.083	1.38
5	5.563	7-5/16	3	1/16	5.345	.109	2.06
6	6.625	8-1/2	3-1/2	1/16	6.407	.109	2.75
8	8.625	10-5/8	4	1/16	8.407	.109	3.88
10	10.750	12-3/4	5	1/16	10.482	.134	7.48
12	12.750	15	6	1/16	12.438	.156	15.00
14	14.000	16-1/4	6	1/16	13.688	.156	19.20
16	16.000	18-1/2	6	1/16	15.670	.165	23.90
18	18.000	21	6	1/16	17.670	.165	28.50
20	20.000	23	6	1/16	19.624	.188	36.30
24	24.000	27-1/4	6	1/16	23.564	.218	56.00